

ARAMINGO SQUARE

3621 ARAMINGO AVENUE, PHILADELPHIA PA

±2,250 SF AVAILABLE FOR LEASE

JOIN



property highlights.

- Highly visible pad opportunity on Aramingo Avenue
- Centrally located in high barrier to entry Port Richmond market
- Full access from Aramingo Ave, Castor Ave, and Venango Street
- Existing drive thru
- Just over 1 mile from I-95 ramp
- Owned and Managed by

BLANK
ASCHKENASY
PROPERTIES



stats.

2017 DEMOGRAPHICS*	1 MILE	3 MILES	5 MILES
EST. POPULATION	33,058	312,942	892,588
EST. HOUSEHOLDS	11,515	104,523	328,289
EST. AVG. HH INCOME	\$43,894	\$44,166	\$57,897

ARAMINGO AVENUE TRAFFIC COUNT: 29,303 VPD *ESRI 2017



METRO[®]
COMMERCIAL
REAL ESTATE, INC.

MetroCommercial.com | PHILADELPHIA, PA | PLYMOUTH MEETING, PA | MOUNT LAUREL, NJ | NAPLES, FL

get in touch.

SCOTT BENSON

office 215.893.0300

direct 215.282.0158

sbenson@metrocommercial.com

Aramingo Avenue 29,303 VPD

Venango Avenue

Castor Avenue 11,312 VPD

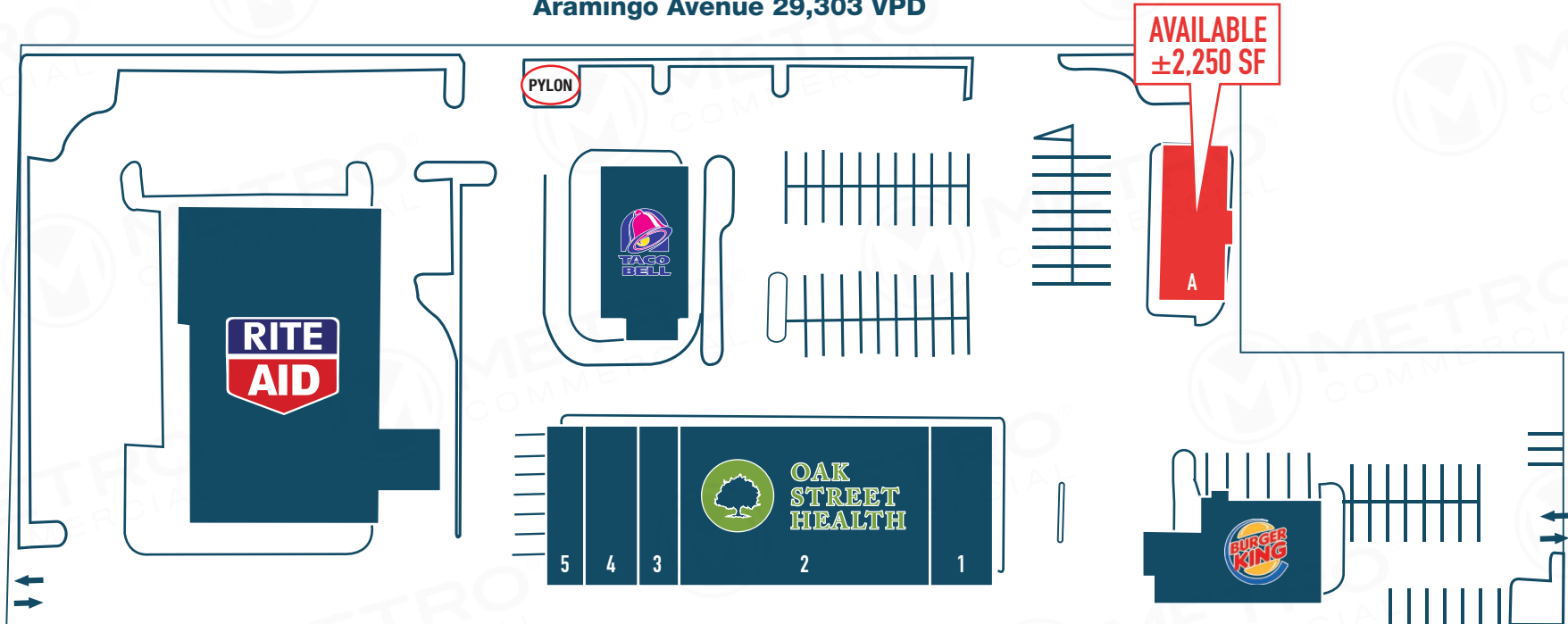

- | | | | |
|---|-------------------|-------|-------------------|
| 1 | SANTANDER BANK | 4 | KEYSTONE REHAB |
| 2 | OAK STREET HEALTH | 5 | ARAMINGO CLEANERS |
| 3 | EDGE CLOTHING | PAD A | AVAILABLE |

**ARAMINGO SQUARE
PHILADELPHIA, PA**

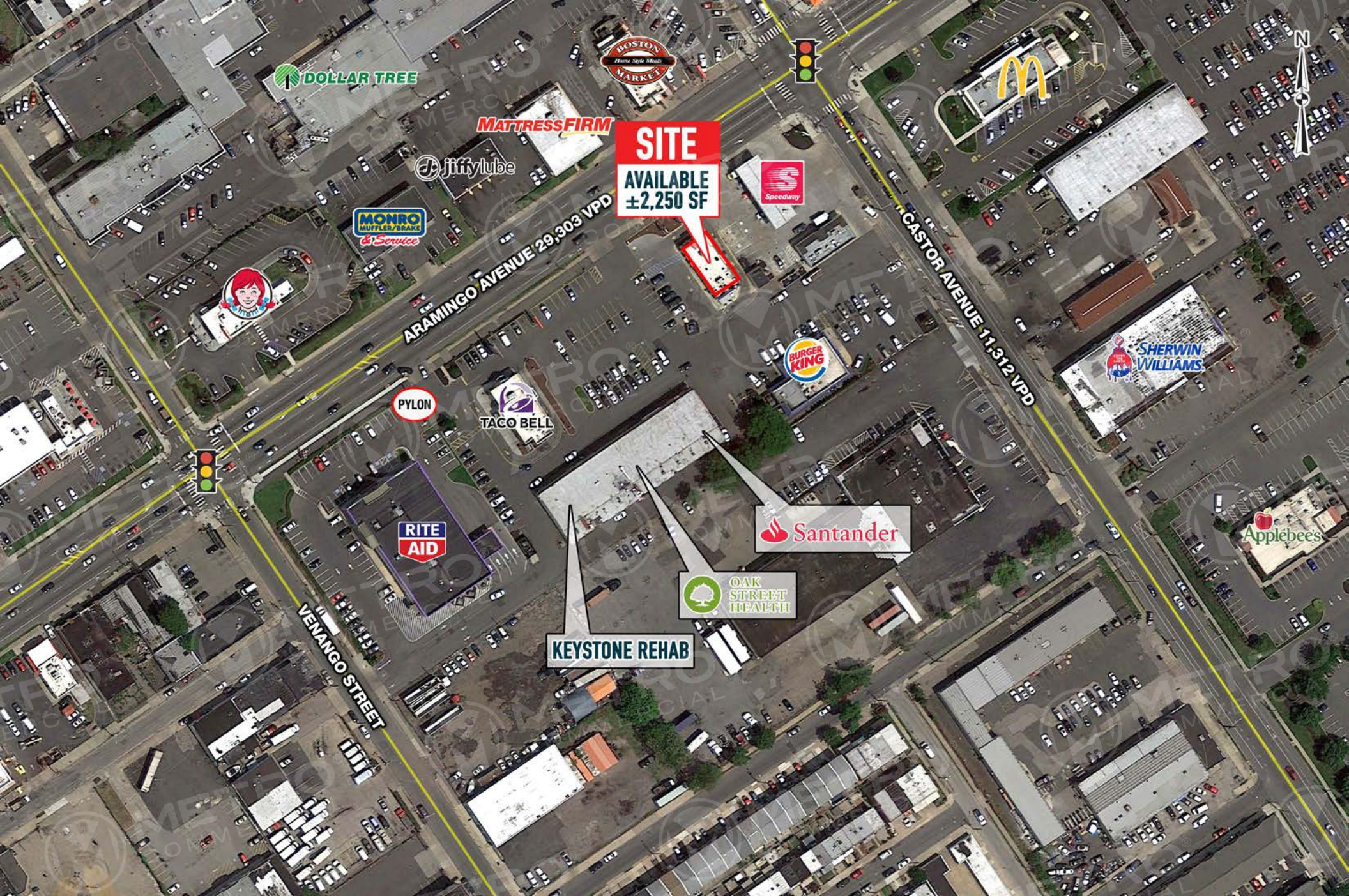

The information and images contained herein are from sources deemed reliable. However, Metro Commercial Real Estate, Inc. makes no representation whatsoever as to their accuracy or authenticity. Images shown may be modified for illustrative purposes. Images may be out-of-date and not current. 7.11.18

ARAMINGO SQUARE
PHILADELPHIA, PA

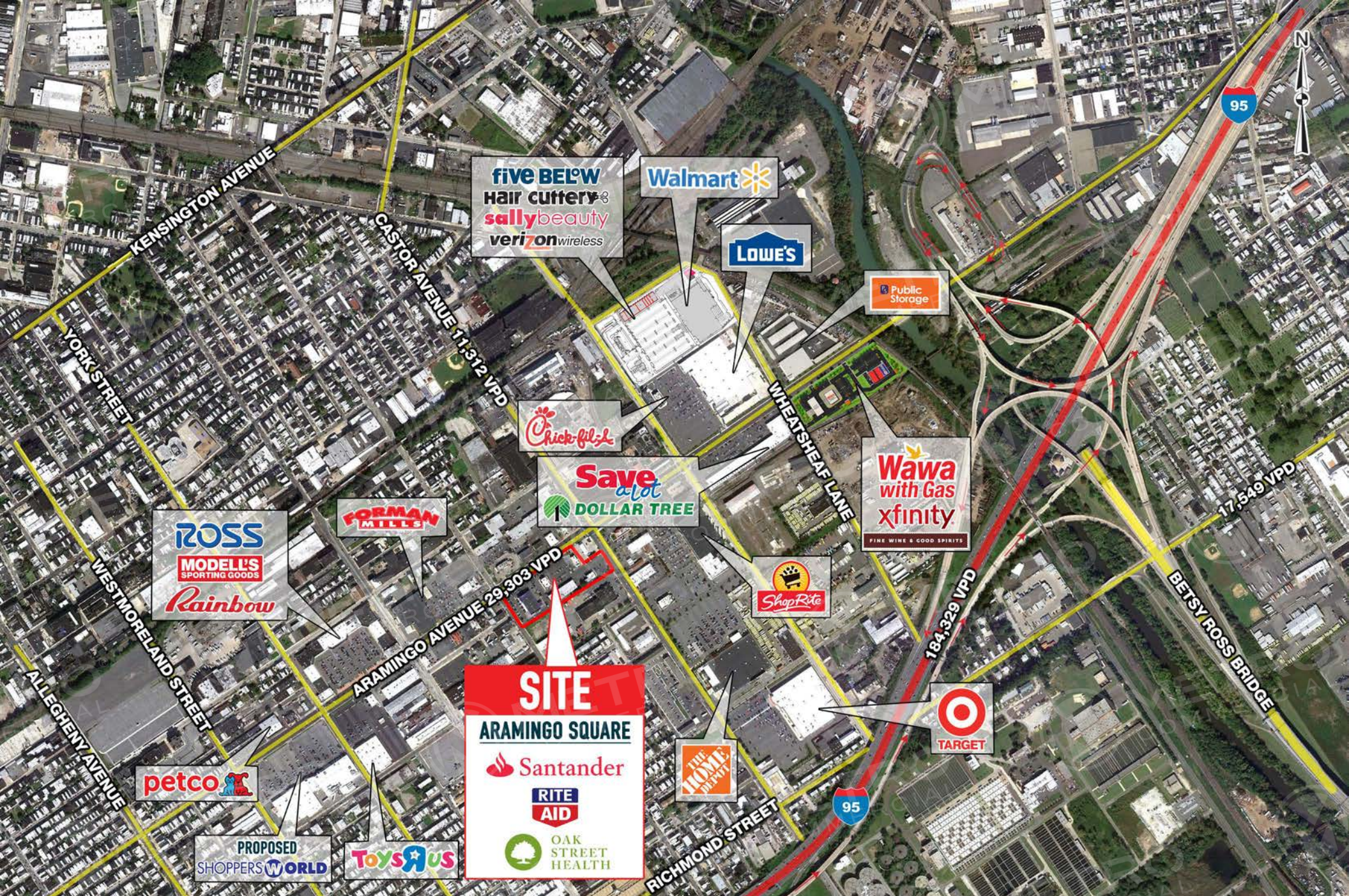

The information and images contained herein are from sources deemed reliable. However, Metro Commercial Real Estate, Inc. makes no representation whatsoever as to their accuracy or authenticity. Images shown may be modified for illustrative purposes. Images may be out-of-date and not current. 7.11.18

ARAMINGO SQUARE
PHILADELPHIA, PA